

## Owners Manual V1.0

### WARNINGS

This owners manual is to assist with the basic assembly and alignment of your bow. It is not a training manual. Do not attempt to use your bow without adequate training from an archery professional. We recommend you utilize the services of an authorised dealer for set up, and a qualified coach for instruction. If you have any doubts on any aspect, please contact your dealer for advice.

**1) Limb Fitting.** The MYKAN uses the standard international limb fitting, 'ILF'. Line up the dovetail fitting of the limb and riser and carefully push the limb into the limb pocket. You should hear a positive 'click' when fully engaged and the limb will not push any further. Ensure the upper limb is in the upper pocket and the lower limb in the lower pocket.

**2) Fit the string** with the aid of a bow stringer (not included). For instructions on how to use a stringer, and string selection, please consult an archery professional. The use of a stringer is the best method for safely stringing your bow.

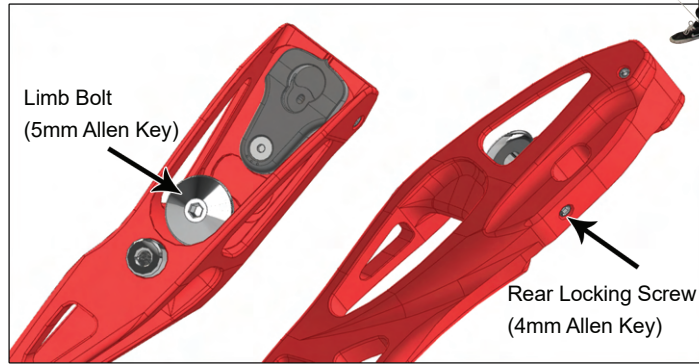
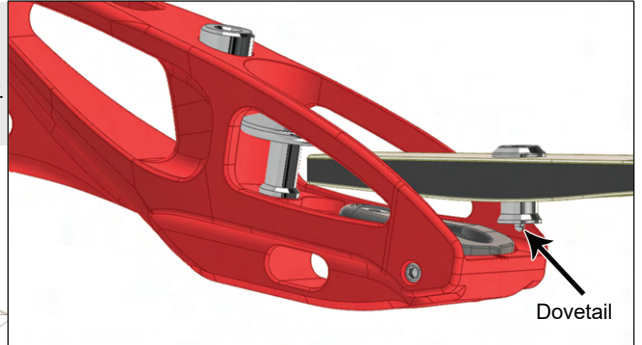
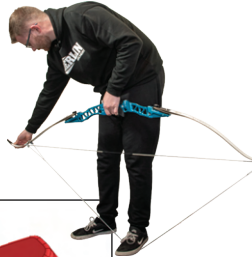

**3) Poundage and tiller** is adjusted using the limb bolts. **IMPORTANT!** Do not undo the limb bolt more than 3 full turns from its fully wound-up position. (Check current position before making any adjustments). Before adjusting the limb bolt, de-string the bow. Then undo the rear locking screw to free the limb bolt. Turning the limb bolts clockwise equally top and bottom will increase the poundage. Anti-clockwise will decrease the poundage. Adjusting one limb bolt independently will adjust the tiller difference between the limbs. Once adjustments have been made, re-tighten the locking screw and re-string to check. Repeat as necessary.

**4) Brace height** is a variable measurement depending on limb brand, limb length and tuning preferences. Brace height is controlled by adjusting the string length. As a starting point consider using the following:

Short Limb: 19.5cm–21.5cm / Medium Limb: 20.5cm–22.5cm  
Long Limb: 21.5cm–23.5cm

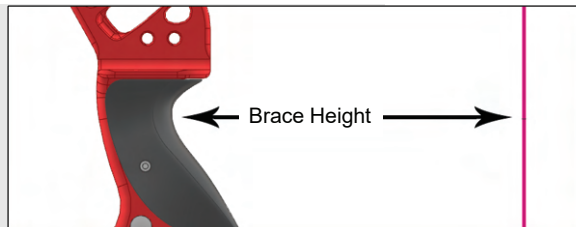

**5) Alignment.** The MYKAN features a lateral adjuster block to best match the limbs to the riser. There are several ways to check limb alignment. We recommend the simple method of stringing your bow and visually aligning the string through the centre of the bow and a long stabiliser.

The string should centrally split the top and bottom of the riser and align centrally down the long stabiliser. See diagram to the right and note point A / B / C. If adjustment is required, small corrections can be made using the adjuster block.



Alignment adjustments are best made while the bow is strung and after tiller and poundage has been set. Make only very small adjustments and re-check each time.

To adjust, undo one of the side locking screws 1/2 turn and tighten opposite screw 1/2 turn. This pushes the adjuster block across, moving the limb and changing the alignment. Adjust to desired position and re-tighten.

Periodically check screws for tightness. Use 'Blue' Loctite 243 medium strength on screws for added security.



## Master Weight

(Available separately)

Lay the anti-vibration weight membrane across the riser. Push the weight smoothly over the membrane allowing it to fold around the riser. Be sure the threaded M6 rear holes of the weight are aligned with the through holes of the riser.

The upper mounting screw uses an M6 x 20mm cap head bolt and spring washer. The lower screw uses an M6 x 30mm cap head bolt and spring washer.

## IMPORTANT!

Ensure the screws have engaged properly with the threads before tightening to prevent cross threading. You may need to re-adjust the weight position and manoeuvre the screws to be sure they are lined up. Fully fit both screws loosely before tightening either screw.

To remove, fully remove the M6 Cap screws and attached a short stabiliser into the 5/16" UNF threaded holes on the master weight to give yourself grip while extracting the weight if required.

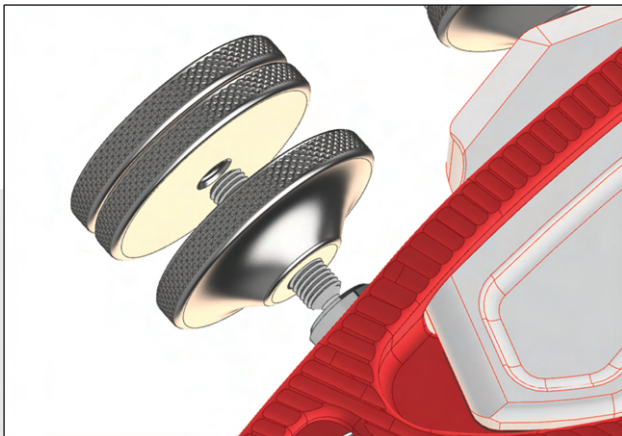
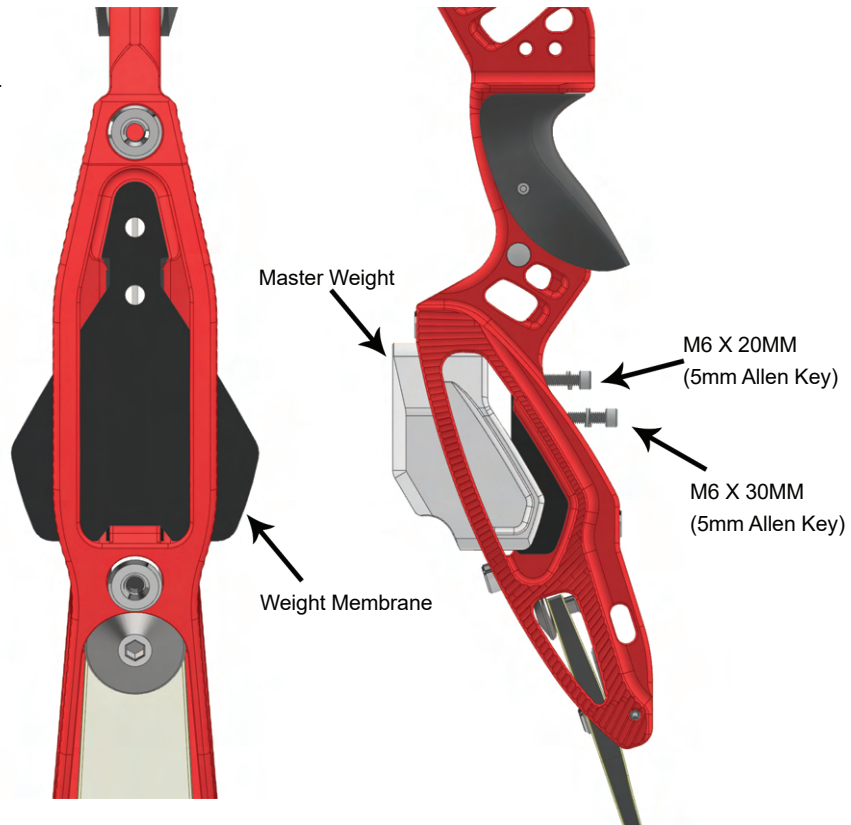

## Stainless Steel Weights (Available separately)

Customize the balance and feel of your the MYKAN with 50mm Stainless steel weights. Weights are stackable and use a standard 5/16" UNF thread.



## Warranty

All MYBO products are covered against defects in materials or workmanship for a minimum period of 1 year to the original owner. Warranty claims after the first year will at the discretion of Mybo and be judged on a case-by-case basis. If your item should develop a fault, first contact the dealer where the item was purchased. We will then work with the dealer to resolve the problem as quickly as possible. The item will either be repaired or replaced. If we replace the item, we reserve the right to change it to a different or newer designed alternative. Issues not covered under warranty are: Fair wear and tear, chips, scratches, or dents. Stripped threads. Rounded or broken screw heads.